

# 1M/2M/3M IN Rollerways

## Exploded View

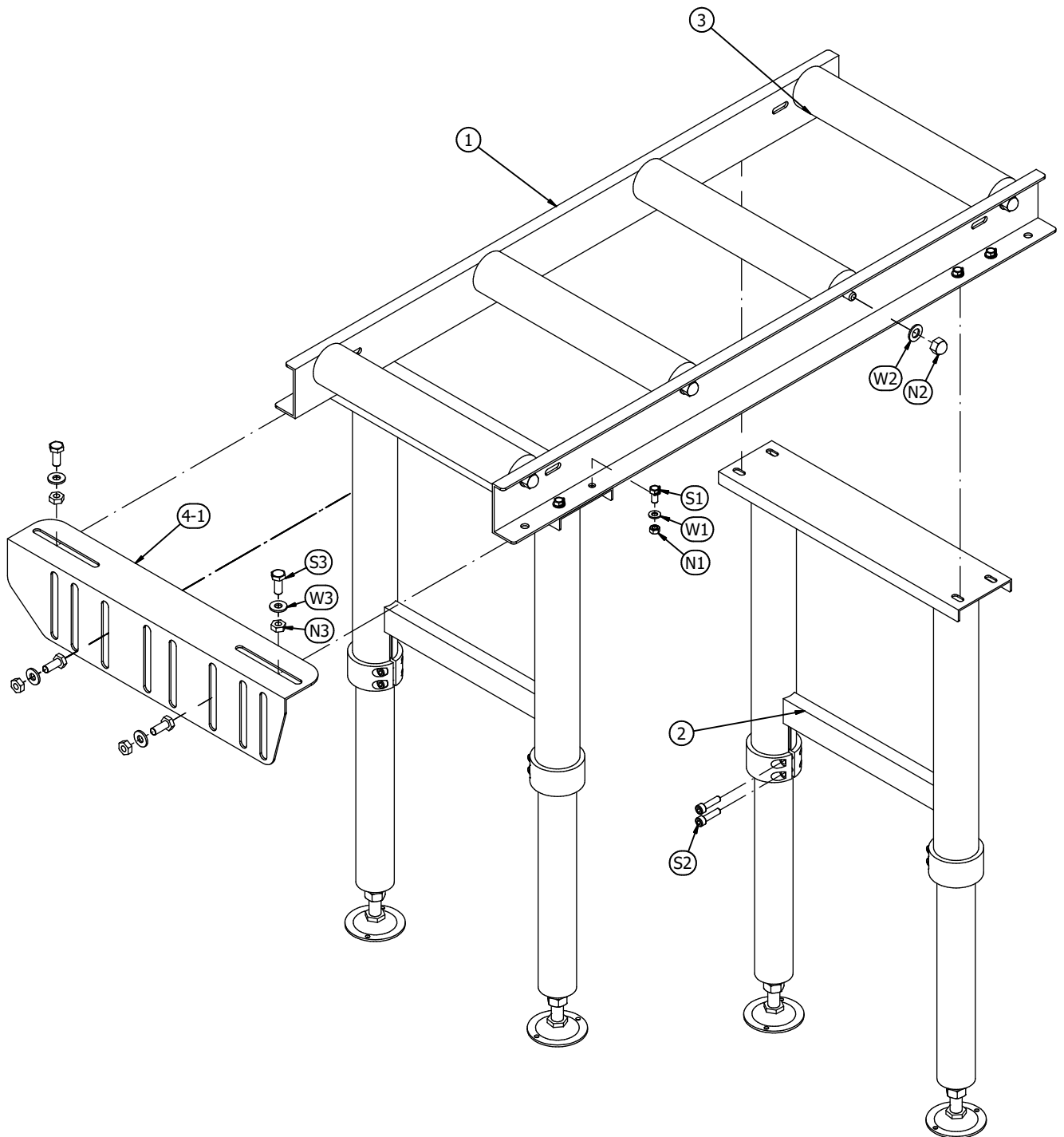

Number	Name	Amount	Number	Name	Amount
1-1	Arm(1M)	2	N1	Nut-M8x5.6	8/8/12
1-2	Arm(2M)	2	N2	Nut-M12	8/16/24
1-3	Arm(3M)	2	N3	Nut-M10x8	4
2	Stand Set	2/2/3	S1	Screw-M8x16	8/8/12
3	Roller	4/8/12	S2	Screw-M8x30	8/8/12
4-1	Fixed Plate	1	S3	Screw-M10x25	4
			W1	Washer-8x16x1.6	8/8/12
			W2	Washer-13x24x2	8/16/24
			W3	Washer-10x23x2.5	4

# 1M/2M/3M OUT Rollerways

## Exploded View

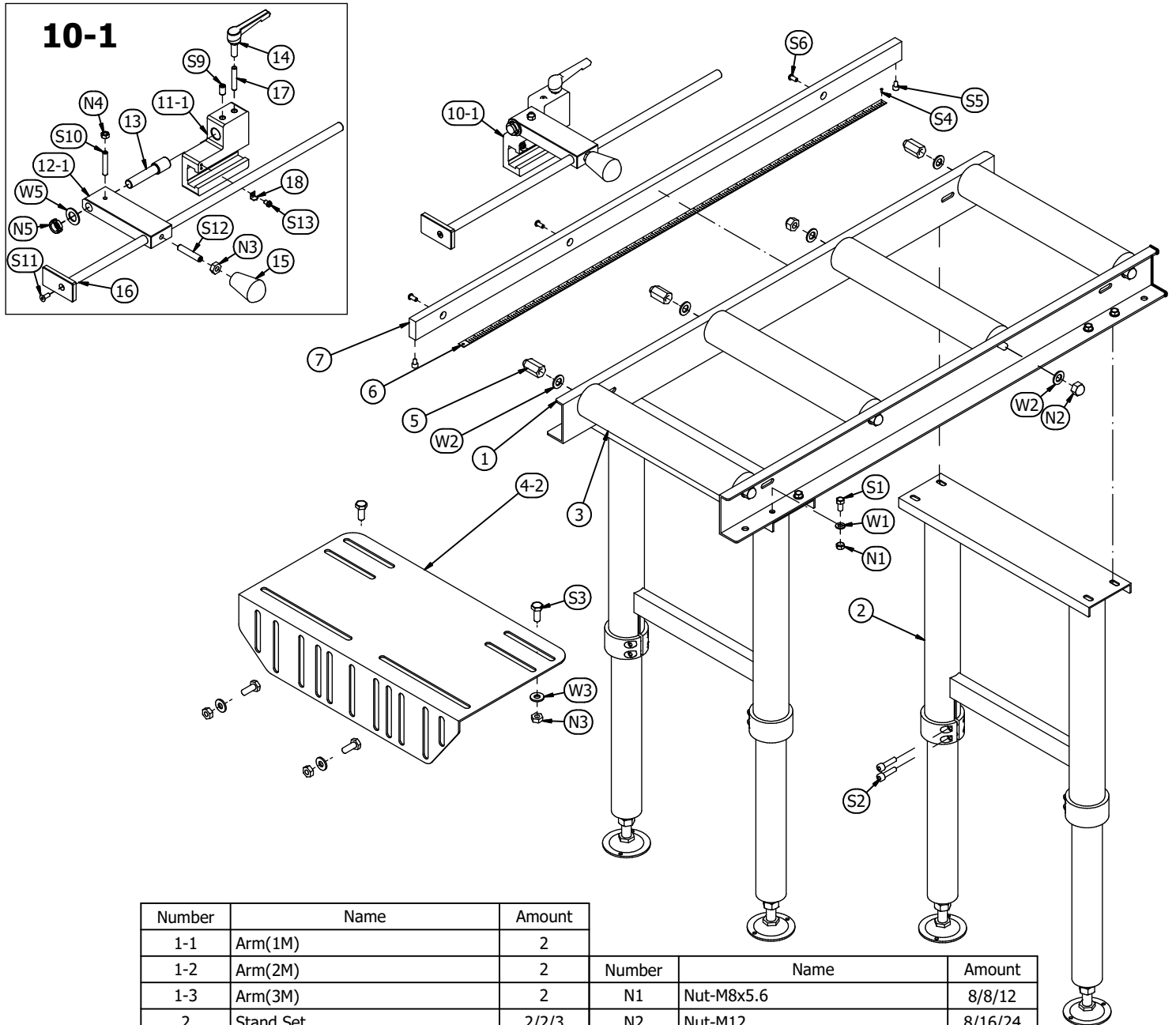

Number	Name	Amount	Number	Name	Amount
1-1	Arm(1M)	2	N1	Nut-M8x5.6	8/8/12
1-2	Arm(2M)	2	N2	Nut-M12	8/16/24
1-3	Arm(3M)	2	N3	Nut-M10x8	5
2	Stand Set	2/2/3	N4	Nut-M8x5.6	1
3	Roller	4/8/12	N5	Nut-M15	1
4-2	Fixed Plate	1	S1	Screw-M8x16	8/8/12
5	Hex Bolt	3/4/6	S2	Screw-M8x30	8/8/12
6-1	Scale(1M)	1	S3	Screw-M10x25	4
6-2	Scale(2M)	1	S4	Screw-2x6	8/15/21
6-3	Scale(3M)	1	S5	Screw-M6x8	2
7-1	Measuring Track (1M)	1	S6	Screw-M6x13	3/4/6
7-2	Measuring Track (2M)	1	S9	Screw-M10x16	1
7-3	Measuring Track (3M)	1	S10	Screw-M8x45	1
10-1	Measurement Set	1	S11	Screw-M6x12	1
11-1	Measurement	1	S12	Screw-M10x50	1
12-1	Fixed Seat	1	S13	Screw-M5x8	1
13	Shaft	1	W1	Washer-8x16x1.6	8/8/12
14	Convenient Handle	1	W2	Washer-13x24x2	8/16/24
15	Handle	1	W3	Washer-10x23x2.5	4
16	Bar Stop Set	1	W5	Washer-17x30x2	1
17	Copper Rod	1			
18	Scale Pointer	1			