

| CODE           | DESCRIPTION                  | CODE      | DESCRIPTION                                  | CODE      | DESCRIPTION                      |
|----------------|------------------------------|-----------|--|-----------|----------------------------------|
| AC010-003      | Connection rest. 1/4"        | SI006-030 | Cylinder gasket 0,30 mm                      | VB003-005 | Screw for filter                 |
| EX041-060      | Piston seal                  | SI006-050 | Cylinder gasket 0,50 mm                      | VB004-005 | Screw for valve                  |
| MSI002-012     | Electric motor 12 Volt 450 W | SI006-080 | Cylinder gasket 0,80 mm                      | VB005-005 | Screw for cylinder               |
| MSI002-901     | Support motor                | SI009-060 | Connecting-rod                               | VB006-010 | Screw for bearing connecting-rod |
| MSI002-901-001 | Milled support motor         | SI009-160 | Connecting-rod complete of bearing and crank | VB006-020 | Screw for piston top             |
| MSI002-902     | Cover motor brush            | SI011-060 | Cylinder                                     | VB006-035 | Screw for top                    |
| MSI002-903-002 | Brush holders motor 12 Volt  | SI011-160 | Cylinder complete of filter and connection   | VD004-005 | Nut for valve                    |
| MSI002-904-001 | Brush                        | SI012-001 | Crank  | VR004-005 | Washer for valve                 |
| SI002-001      | Head                         | SI034-060 | Piston top                                   | VR006-005 | Washer                           |
| SI003-001      | Top gasket                   | SI036-001 | Cover filter                                 |           |                                  |
| SI004-001      | Valve                        | SI037-001 | Filter                                       |           |                                  |
| SI005-001      | Valve plate                  | SI039-001 | Bearing connecting-rod                       |           |                                  |
| SI005-101      | Valve plate complete         | VB006-010 | Screw for bearing connecting-rod             |           |                                  |

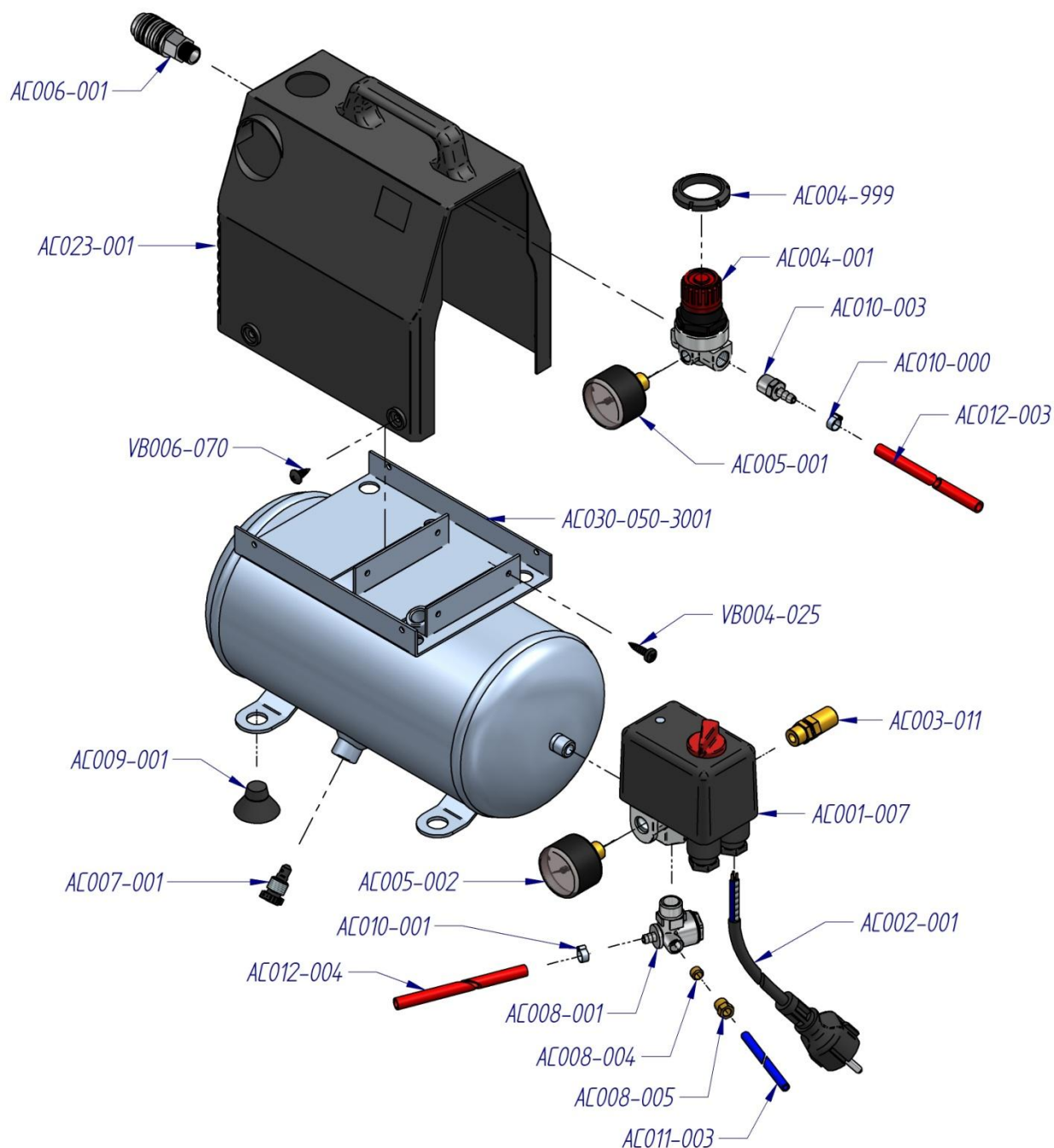

| CODE          | DESCRIPTION                               | CODE      | DESCRIPTION                                      | CODE           | DESCRIPTION                             |
|---------------|---|-----------|--|----------------|---|
| AC001-007     | Pressure Switch 3/8" (start valve close)  | AC006-005 | Nut for Bayonet connection                       | AC012-003      | Red Rilsan tube SILV. 2 for Pressure    |
| AC001-007-001 | Pressure Switch complete for SILVESTONE 2 | AC007-001 | Plastic screw for condensate drain               | AC012-004      | Red Rilsan tube SILV. 2 for non return  |
| AC002-001     | Pin plug SHUKO 1,5 m                      | AC008-001 | Not return valve 3/8" for tube Rilsan            | AC023-001      | Plastic Cover black                     |
| AC002-105     | Pin plug ENGLISH 1,5 m                    | AC008-004 | Ogive for tube blue Rilsan                       | AC023-001-001  | Plastic Cover complete for SILVESTONE 2 |
| AC003-011     | Safety valve 8 BAR                        | AC008-005 | Nut for tube blue Rilsan                         | AC030-050-3001 | Tank model SILVESTONE 2 "RED"           |
| AC004-001     | Pressure regulator MIGNON Pos.1           | AC009-001 | Rubber foot                                      | VB004-025      | Screw                                   |
| AC005-001     | Manometer 40 mm 1/8" Bar/Psi              | AC010-000 | Clip for tube 8,0 mm                             | VB006-070      | Screw                                   |
| AC005-002     | Manometer 40 mm 1/4" Bar/Psi              | AC010-001 | Clip for tube 8,5 mm                             |                |   |
| AC006-001     | Universal Coupler 1/4" Male               | AC010-003 | Connection 1/4" Male for Rilsan tube 6 mm inside |                |   |
| AC006-004     | Pin cock (Bayonet) 1/4" Male              | AC011-003 | Blue Rilsan tube SILVESTONE 2                    |                |   |